



Exhibition inspirations

Funeral Industry

Trade Show Booths 3.0

What are Clever Frame® modular exhibition systems and what makes them so popular?



Clever Frame® modular exhibition systems offer great versatility in terms of design, available features, and configuration options. As the name suggests, they consist of individual modules that can be used in various ways – for example, by combining them into large-scale trade show booths or creating compact promotional walls. These systems can be customized in terms of structure and visual appearance, providing limitless opportunities for brand image building.

In mature marketing, there is no room for experiments at the expense of efficiency. This guide presents proven exhibition solutions that we have been delivering to companies like yours for years.



Learn more at www.cleverframe.com



Why are Clever Frame® modular booths

so popular among exhibitors?



**Clever Frame®
modular exhibition
systems**

**Traditional
custom-made trade
show booths**

Reusable	✓	✗
Budget savings	✓	✗
Eco-friendly design approach	✓	✗
Tool-free assembly	✓	✗
Freedom to reconfigure and change the graphic design	✓	✗

How does the Clever Frame® system work?

Quickly, intuitively, conveniently!



01

The booth structure consists of frames. The more frames you have, the larger the setup you can create.



02

Assembly of the system is easy and intuitive. Thanks to special connectors, no tools are needed.



03

The booth's graphic display is made using magnetic panels - their installation takes just a few seconds.

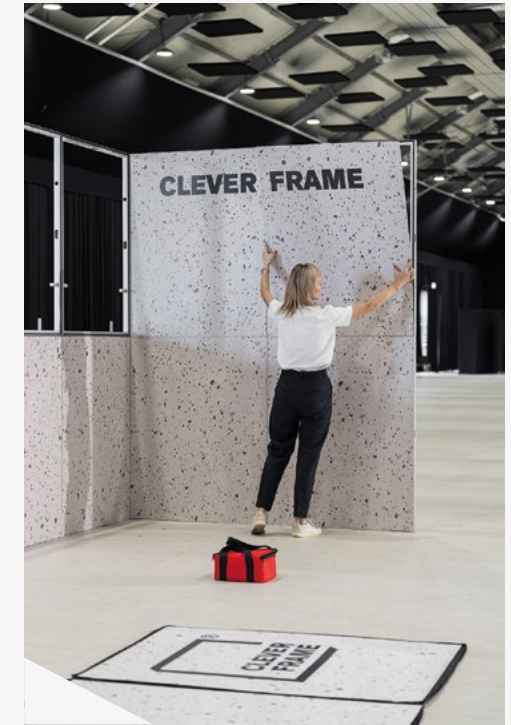

04

The booth is quickly ready for use. If needed, you can reconfigure it as desired.

Exhibition inspirations



See what your trade show booth could look like!



Small modular stands



Small modular stands



Small modular stands



Small modular stands



Small modular stands



Small modular stands

Tell us what you need!

Our designers will help you create a booth tailored to your needs.

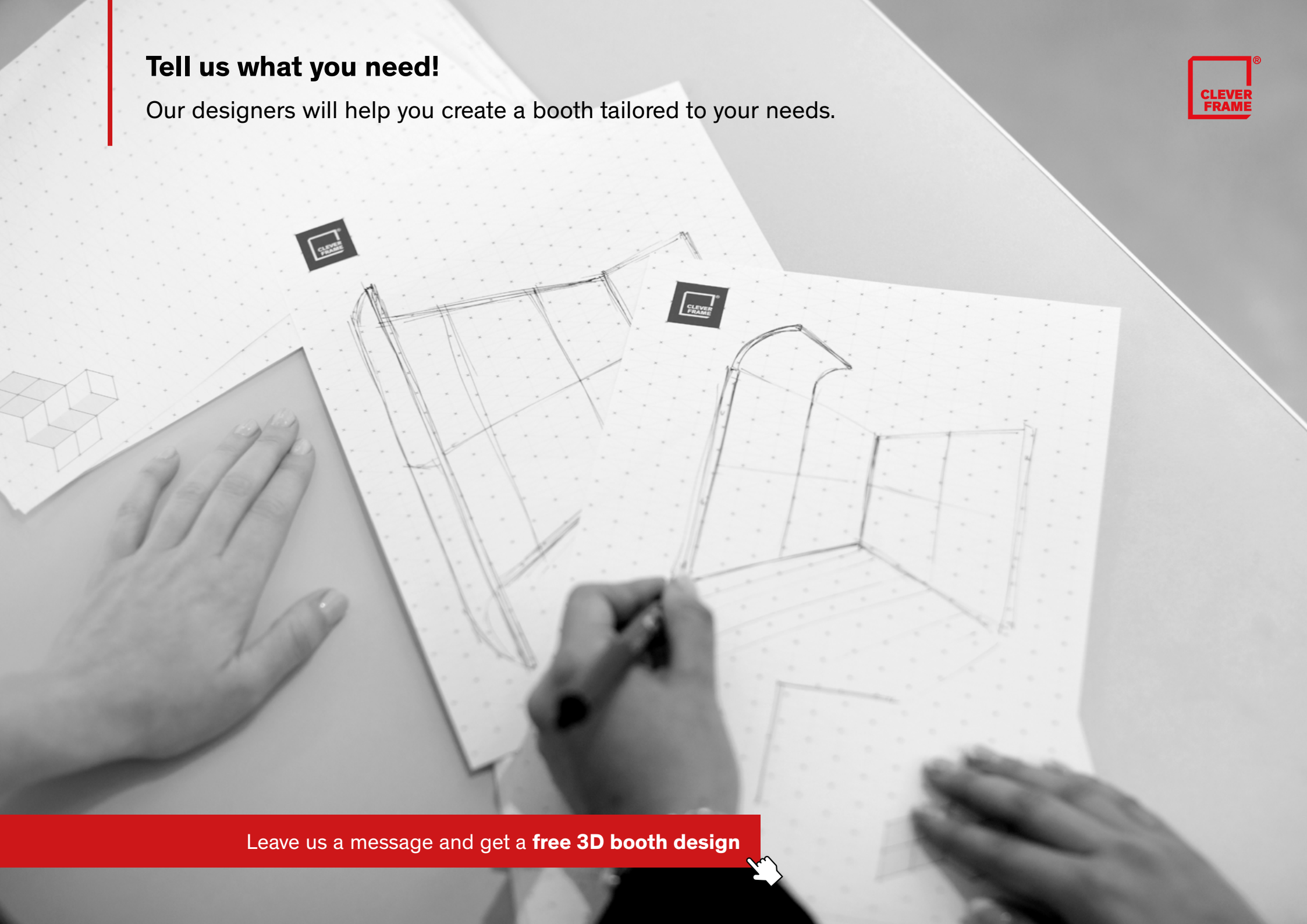

Leave us a message and get a **free 3D booth design**



Support at every stage

Comprehensive services that will save you time



**Assembly and disassembly
of trade show booths**



**Transport within the
European Union**



**Storage of trade
show booths**



**Leasing
and financing**

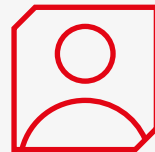

**Support from a dedicated
account manager
and designer**



**Option to rent
exhibition stands**

[Learn more about our additional services](#)



Clever Frame® around the world



**25 YEARS OF EXPERIENCE,
THOUSANDS OF COMPLETED
PROJECTS**

We are a manufacturer with many years of experience, which means we know almost everything about exhibition systems. We design, produce, and test them – delivering arrangements that are complete both technically and visually.

In one place, without time-consuming research, you can order any advertising systems from us – trade show booths, event setups, or retail furniture.

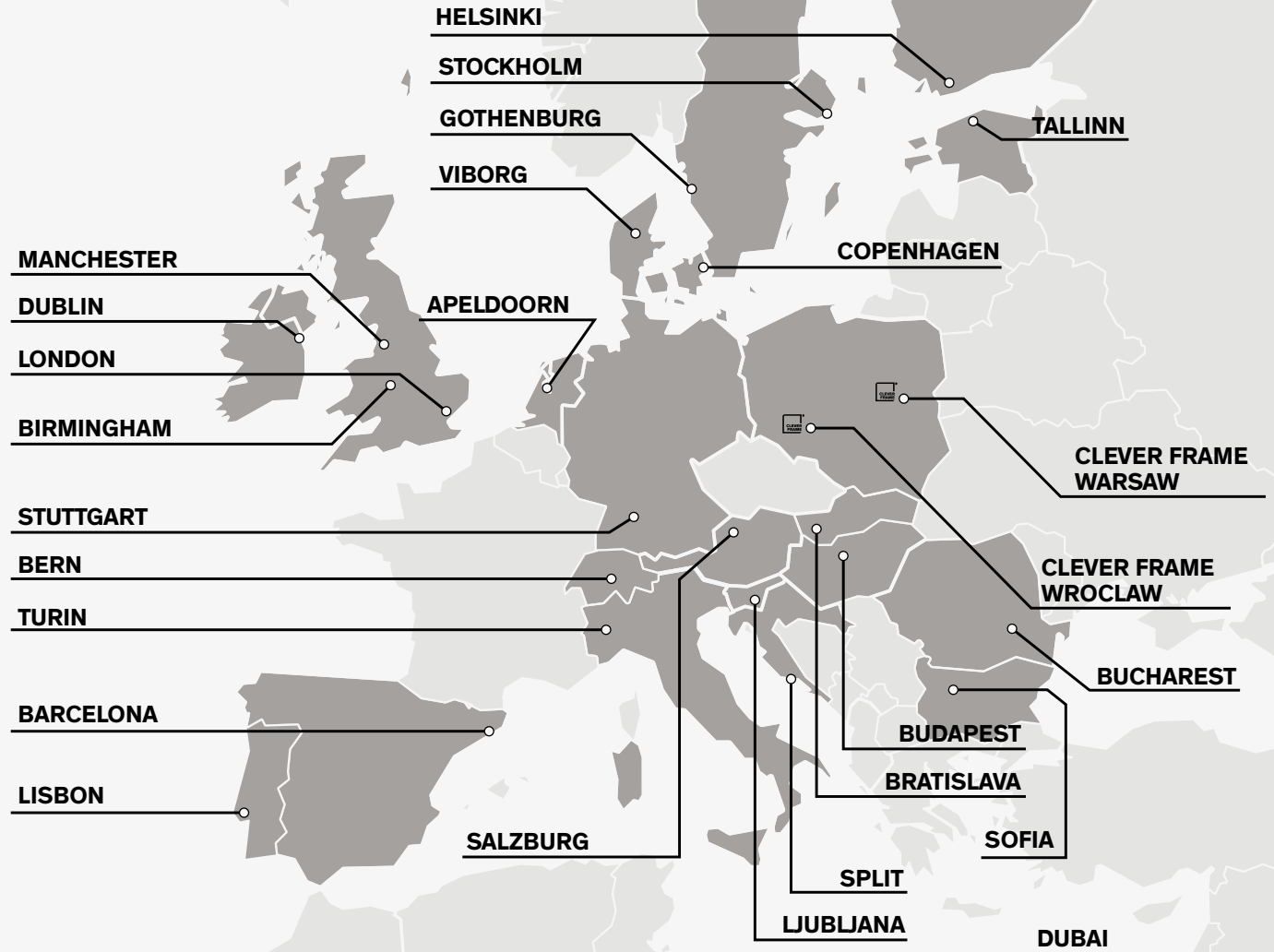

They trusted us

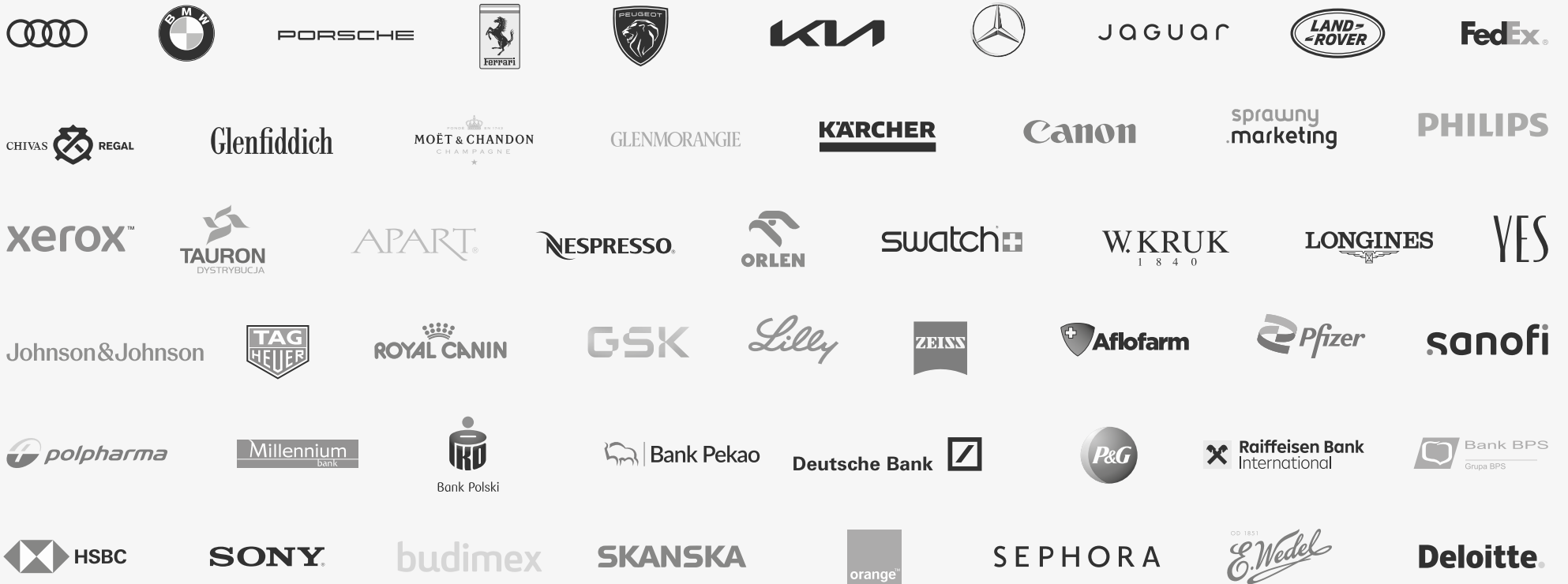

All other trademarks are the property of their respective owners.

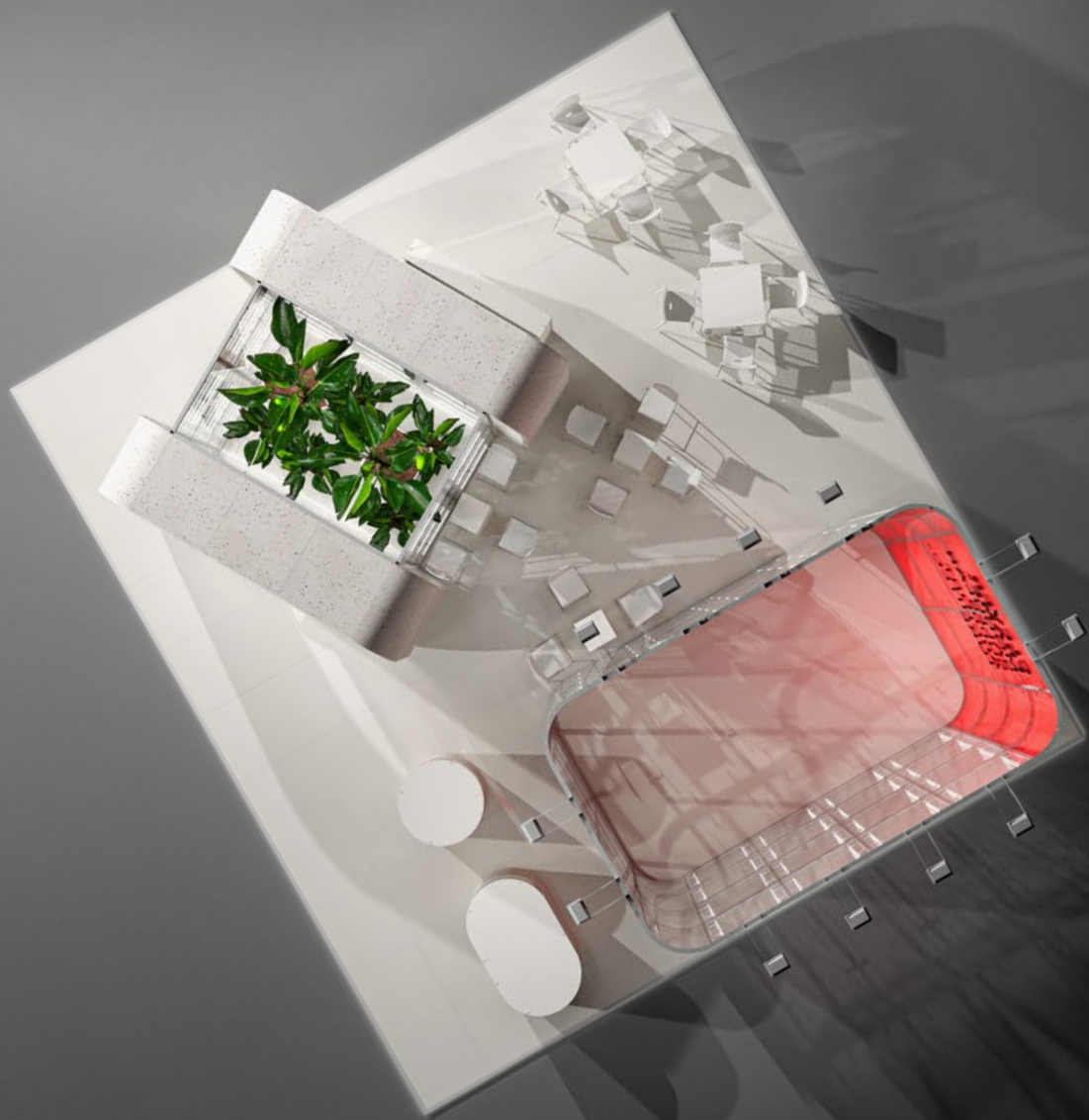

Clever Frame sp. z o.o.

E: office@cleverframe.com
www.cleverframe.com